

# KEYCREATOR 3D Direct Modeling Software

## KeyCreator Lesson KC8504

### Evaluating Parts with Missing Faces

In our previous exercises we looked at situations where dimensions differed from the Is to the Was part.

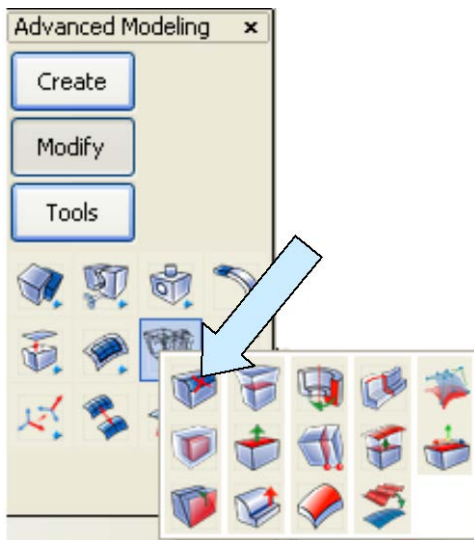
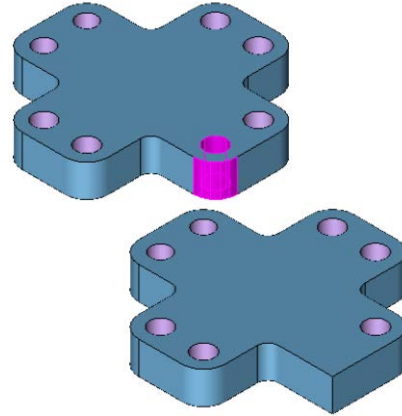

In this exercise we'll look at what happens when one of the parts is actually missing faces. In this case you will have one or more missing pairs. Start by opening up the TestIs File that you created in lesson KC8501

Click on the REMOVE FEATURE Icon.

Then, click on the hole and the blend indicated by arrows in the illustration to the right.

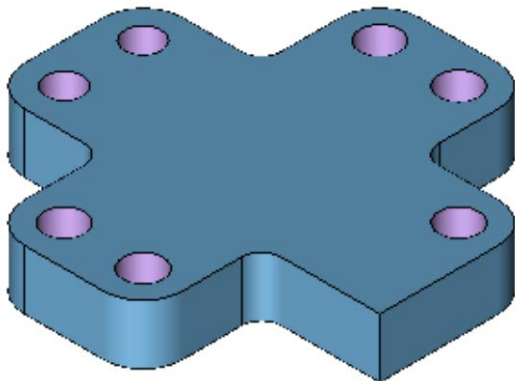
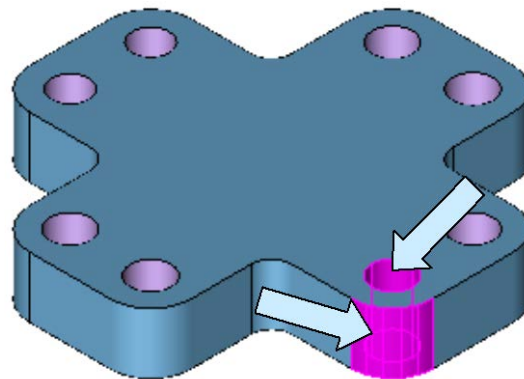

Your part should now look like this:

Click on the SAVEAS Icon and save this file as "TestIs3."

# KEYCREATOR 3D Direct Modeling Software

## Comparing the Parts

Click on the VALIDATE PARTS Icon.

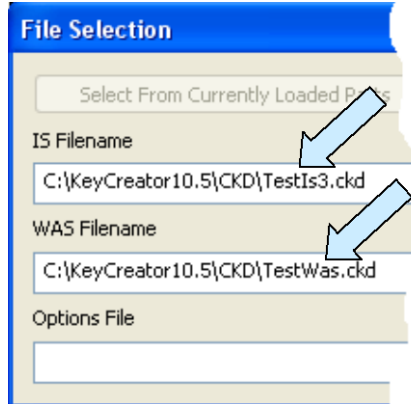
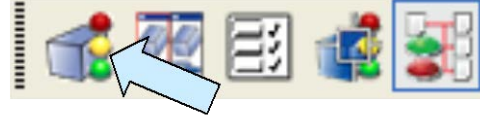

A Dialog Box appears.

Click on the browse button to the right of the IS Filename Field and select the “TestIs3” file that you just saved.

Then, use the browse button to the right of the WASFilename Field and select the “TestWas” file from lesson KC8501. Click on the OK Button.

The IS and WAS files appears. Click on the Root Folder. Notice that the two holes that differ on the left leg of the part show up in the IS and WAS Models. In addition, the WAS model shows the orphan corner blend and hole.

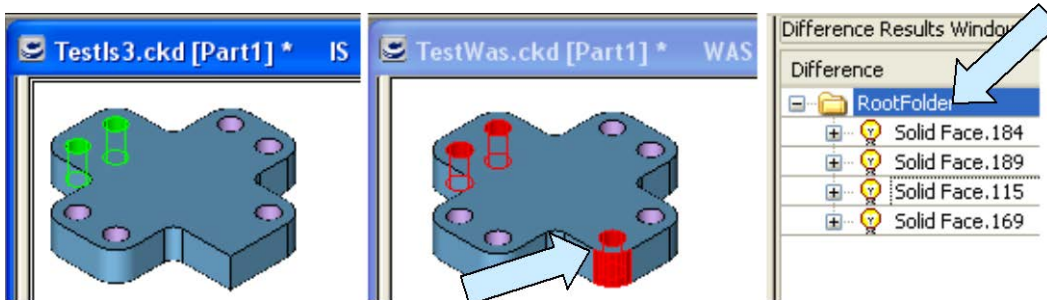

If you click on the “+” signs in the Difference Results Window, you’ll see a fundamental difference between items like the two holes on the left leg of the part and the orphan features on the right leg.

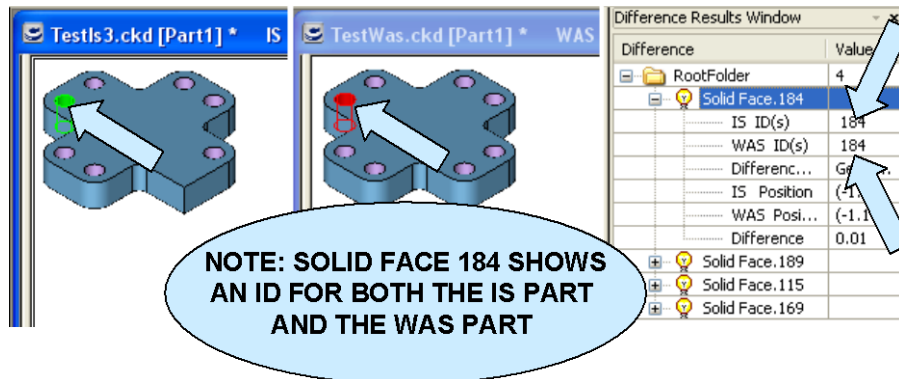

# KEYCREATOR 3D Direct Modeling Software

If you look at either of the orphan features, you will see that there is an ID for the feature on the WAS part and obviously no ID for the IS part.

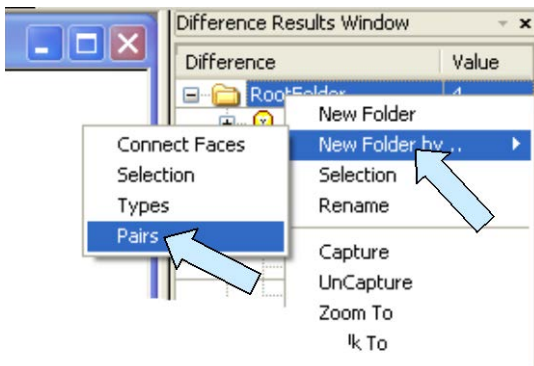
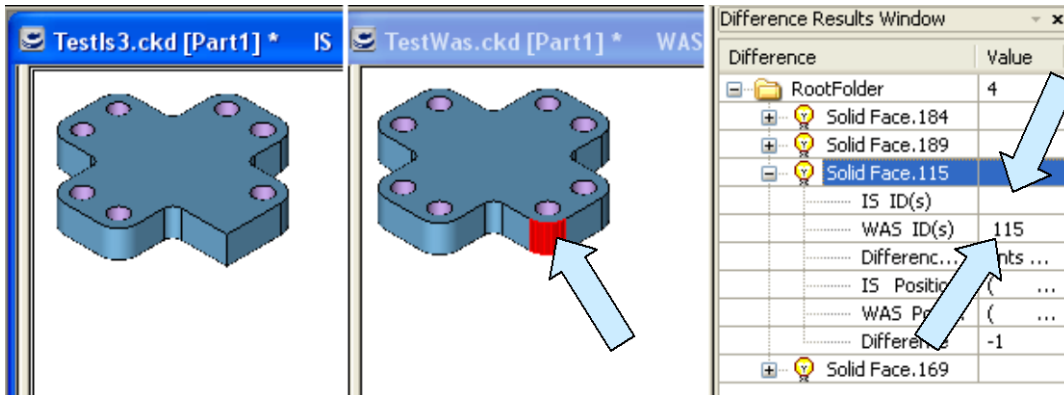

An alternate way to work with the data in the Difference Results Window is to Right Mouse Click on the Root Folder Row and then select the New Folder By Pairs Option.

The data is now presented in two sections. The Pairs section contains each pair of faces that don't match from part to part.

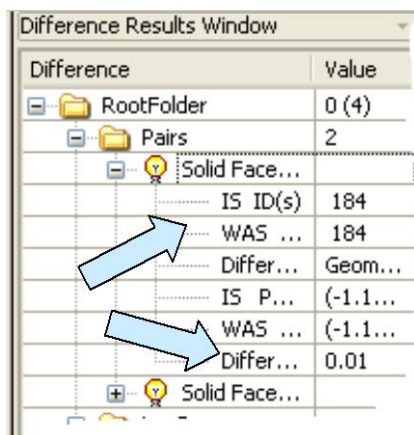
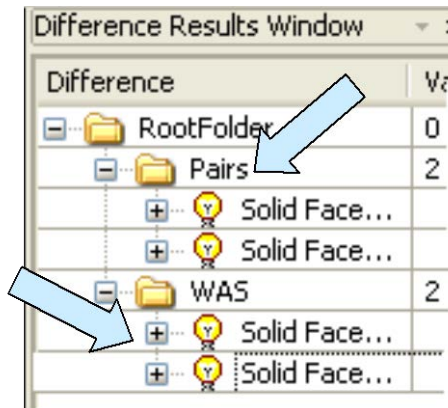

The WAS section contains the faces that have no matching companion on the IS part.

If you expand an entry in the Pairs section, you'll see the same comparison data that was presented when you used the previous display mode in the Difference Results Window.

# KEYCREATOR 3D Direct Modeling Software

As you click on each item in the Difference Results Window, the corresponding pair of faces or orphan face highlights in the model(s).

